

I - CARACTERISTIQUES TECHNIQUES MODELES	Pertes statiques Qpr	DIMENSIONS EN mm											Poids net
I - TECNISCHE KENMERKEN MODELLEN	Statische lossen	AFMETINGEN IN mm											Netto gewicht
I - TECNISCHE MERKMALE MODELLE	Bereitschafts -Energieverbrauch	ABMESUNGEN IN mm											Netto gewicht
I - TECHNICAL CHARACTERISTICS MODELS	Static losses	DIMENSIONS IN mm											Net weight
	kWh/24h à 65°C	A	B	C	D	E	F	G	H	J	L	kg	
<b>GAMME STEATITE &amp; PROFESSIONAL TECH - STEATITE GAMMA &amp; PROFESSIONAL TECH - SERIE STEATTI &amp; PROFESSIONAL TECH - CERAMIC CORE ELEMENT &amp; PROFESSIONAL TECH - GAMMA ESTEATITA &amp; PROFESSIONAL TECH - GAMMA STEATITE &amp; PROFESSIONAL TECH - GAMMA ESTEATITE &amp; PROFESSIONAL TECH</b>													
<b>Vertical - Vertikaal - Vertikal - Verticale</b>													
050 VERT 460 STEAMO - GE	0,89	410	-	560	160	120	460	475	G1/2	-	-	18	
075 VERT 460 STEAMO - GE	1,20	590	-	760	230	175	460	475	G3/4	-	-	24	
075 VERT 460 PTEC MO - GE	1,20	590	-	790	230	175	460	475	G3/4	-	-	24	
100 VERT 505 STEAMO	1,30	560	-	830	230	175	505	510	G3/4	-	-	31	
150 VERT 505 STEAMO / TR	1,70	1050	800	1150	230	175	505	510	G3/4	-	-	39	
200 VERT 505 STEAMO / TR	2,17	1050	800	1480	230	175	505	575	G3/4	-	-	47	
100 VERT 560 STEAMO / PTEC / DIY / HPC *	1,05 / 1,03*	530	-	750	230	175	560	575	G3/4	-	-	31	
150 VERT 560 STEAMO / TR / PTEC / DIY / HPC *	1,54 / 1,41*	750	500	1010	230	175	560	575	G3/4	-	-	39	
200 VERT 560 STEAMO / TR / PTEC / DIY / HPC *	1,85 / 1,85*	1050	800	1270	230	175	560	575	G3/4	-	-	47	
100 VERT 530 HPC MO	1,06	560	-	835	230	175	530	545	G3/4	-	-	32	
150 VERT 530 HPC MO	1,35	1050	800	1160	230	175	530	545	G3/4	-	-	40	
200 VERT 530 HPC MO	1,76	1050	800	1480	230	175	530	545	G3/4	-	-	49	
<b>Sur socle - Op sokkel - Auf sockel - Free standing - Sobre zocao - Su zoccolo - No suportes</b>													
200 STAB 560 STEA MT	1,88	-	-	1300	-	-	560	625	G3/4	-	390	54	
250 STAB 560 STEA MT	2,17	-	-	1540	-	-	560	625	G3/4	-	365	61	
300 STAB 560 STEA MT	2,60	-	-	1800	-	-	560	625	G3/4	-	365	75	
200 STAB 560 STEA PTEC MT	1,88	-	-	1300	-	-	560	650	G3/4	-	390	54	
300 STAB 560 STEA PTEC MT / DIY	2,60	-	-	1800	-	-	560	650	G3/4	-	365	75	
250 STAB 570 HPC MT	2,17	-	-	1670	-	-	570	660	G3/4	-	380	55	
270 STAB 570 HPC MT - QUIE - ZEN	2,30	-	-	1800	-	-	570	660	G3/4	-	380	64	
300 STAB 570 HPC MT - QUIE - ZEN	2,45	-	-	1950	-	-	570	660	G3/4	-	380	77	
<b>HORIZONTAL - HORIZONTAAL - ORIZZONTALE</b>													
100 HORB 560 STEA MO	1,65	-	280	750	320	-	560	-	G3/4	260	-	30	
150 HORB 560 STEA MO	2,25	-	500	1010	460	-	560	-	G3/4	260	-	38	
200 HORB 560 STEA MO	2,68	-	800	1270	580	-	560	-	G3/4	260	-	46	
<b>GAMME BLINDEE - BARKERBUIJS GAMMA - GESCHLOSSENE AUSFÜHRUNG - STEEL ALLOY ELEMENT - GAMA BLINDADA - GAMME BLINDATA - GAMMA BLINDADA</b>													
<b>Vertical - Vertikaal - Vertikal - Verticale</b>													
050 VERT 460 THER MO - GE	0,89	410	-	560	160	120	460	475	G1/2	-	-	17	
075 VERT 460 THER MO - GE	1,19	590	-	760	230	175	460	475	G3/4	-	-	23	
100 VERT 505 THER MO	1,32	560	-	830	230	175	505	510	G3/4	-	-	29	
150 VERT 505 THER MO / TR	1,72	1050	800	1150	230	175	505	510	G3/4	-	-	37	
200 VERT 505 THER MO / TR	2,15	1050	800	1480	230	175	505	510	G3/4	-	-	45	
100 VERT 560 THER MO	1,03	530	-	750	230	175	560	575	G3/4	-	-	29	
150 VERT 560 THER MO	1,41	750	500	1010	230	175	560	575	G3/4	-	-	37	
200 VERT 560 THER MO	1,85	1050	800	1270	230	175	560	575	G3/4	-	-	45	
<b>Sur socle - Op sokkel - Auf sockel - Free standing - Sobre zocao - Su zoccolo</b>													
200 STAB 560 THER MT	1,88	-	-	1300	-	-	560	625	G3/4	-	390	50	
250 STAB 560 THER MT	2,17	-	-	1540	-	-	560	625	G3/4	-	365	61	
300 STAB 560 THER MT	2,6	-	-	1800	-	-	560	625	G3/4	-	365	71	
500 STAB 714 THER MT	3,60	-	-	1870	-	-	714	-	G1*	-	335	95	
<b>HORIZONTAL - HORIZONTAAL - ORIZZONTALE</b>													
100 HORD 505 THER MO	1,94	560	345	830	230	175	505	510	G3/4	-	-	30	
150 HORD 505 THER MO	2,17	1050	235	1150	230	175	505	510	G3/4	-	-	38	
200 HORD 505 THER MO	2,66	1050	800	1460	230	175	505	510	G3/4	-	-	46	
75 HORD 460 THER MO - GE	1,69	590	370	760	230	175	460	475	G3/4	-	-	23	
100 HORD 560 THER MO	1,37	530	280	750	230	175	560	575	G3/4	-	-	30	
150 HORD 560 THER MO	1,87	750	500	1010	230	175	560	575	G3/4	-	-	38	
200 HORD 560 THER MO	2,07	1050	800	1270	230	175	560	575	G3/4	-	-	46	
100 HORB 560 THER MO	1,65	-	280	750	320	-	560	-	G3/4	260	-	30	
150 HORB 560 THER MO	2,25	-	500	1010	460	-	560	-	G3/4	260	-	38	
200 HORB 560 THER MO	2,68	-	800	1270	580	-	560	-	G3/4	260	-	46	

\* Valeur pour gamme HPC (d560) - waarde voor reeks HPC (d560) - value for HPC (d560) range - wert für HPC (d560) bereich

Tab caract big neutre

VERTICAL  
VERTIKAAL  
VERTIKAL

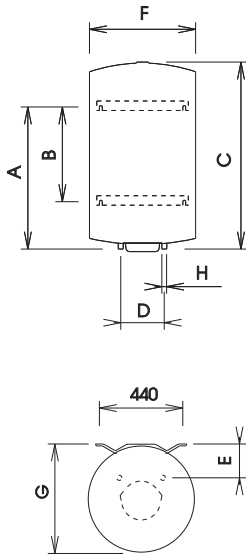

HORIZONTAL - HORIZONTALAAL

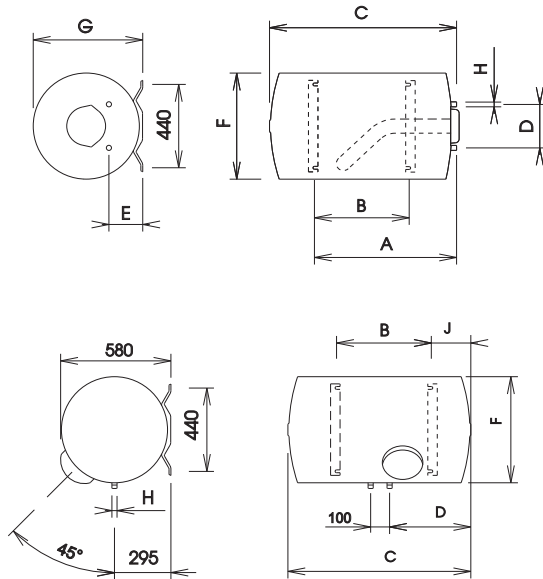

SOCLE - OP SOKKEL - AUF SOCKEL - FREE STANDING

200-300

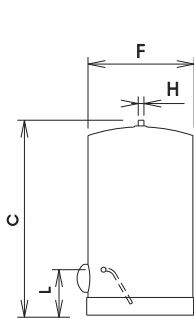

500

